

MEETING OF THE BOARD OF TRUSTEES
OF THE EVERGREEN STATE COLLEGE

Thursday, November 10, 1977
The Evergreen State College Campus
Daniel J. Evans Library, Room 3112

Trustees Present: Wesley E. Berglund
Robert J. Flowers
Herbert D. Hadley
Halvor M. Halvorson

Staff Present: Walker Allen, Registrar
Judy Annis, Director of Information Services
Dave Carnahan, Associate Dean of Library Services
Dean Clabaugh, Administrative Vice President
George Dimitroff, faculty member (seated at Board table)
Les Eldridge, Assistant to the President
Daniel Evans, President
Rita Grace, Recording Secretary
Ed Kormondy, Vice President and Provost
Bill Robinson, Budget Officer (seated at Board table)
Mack Smith, Security Chief
Dan Weiss, Assistant Director of Facilities
Ron Woodbury, TESC Federation of Teachers and faculty member
See permanent roster for others attending

Others Present: Donna Hayes, student (seated at Board table)
John Keogh, Cooper Point Journal
Richard Montecucco, Assistant Attorney General
Alice Watts, The Daily Olympian
See permanent roster for others attending.

The meeting was called to order at 10:30 AM by Chairman Hadley.

APPROVAL OF MINUTES - Action

Motion Mr. Flowers moved approval of the minutes of the October 20, 1977
77-50 meeting as submitted. Seconded by Mr. Berglund and passed.

PRESIDENT'S REPORT

Strike Contingency - progress report

Mr. Eldridge reviewed Resolution No. 77-3 delegating powers and duties in the event of an employees' strike and reported progress of a committee reviewing alternatives to the strike policy adopted June 22.

Ron Woodbury, representing The Evergreen State College Federation of Teachers, read a Federation executive committee statement objecting to the strike policy advisory group's composition and to any report or policy the committee might recommend.

PRESIDENT'S REPORT - Continued

Alaska Peninsula Project

Faculty member Oscar Soule introduced the presentation regarding the Alaska Peninsula Project, which came about initially through the efforts of student Jack Van Valkenburgh, and was funded \$33,000 from the U. S. Fish and Wildlife Service. A slide presentation by participating students followed.

Election Results

President Evans discussed the enrollment loss and some implications of the passage of Initiatives 345 and 348.

Parking

Mr. Clabaugh asked the Trustees to consider a minor change in the parking policy -- the elimination of parking fees after 4:00 PM -- at the next meeting.

Motion
77-51

Mr. Halvorson moved to place on the agenda of the next meeting a public hearing under the Administrative Procedures Act to consider revision to WAC 174-116-105 relating to campus parking and traffic regulations. Seconded by Mr. Flowers and passed.

PROPOSAL FOR FEE CHARGES FOR TRANSCRIPTS - Discussion

Registrar Walker Allen proposed a \$5 charge for transcript reproductions, unless a \$1/page charge were less. Donna Hayes, student seated at the Board table, read a memorandum from the Services and Activities Fees Review Board asking that action be deferred and that a DTF be charged to investigate alternatives for funding transcripts.

Motion
77-52

Mr. Halvorson moved to leave the proposal for fee charges for transcripts on the agenda for the December meeting. Seconded by Mr. Flowers and passed.

USE OF \$15 LATE FEE - Discussion

Mr. Clabaugh asked that the \$15 late fee disposition item be removed from the agenda to permit further discussions with legal counsel.

PROGRESS REPORT ON ENROLLMENT PROJECT

Ed Kormondy reviewed the college's efforts and plans for increasing winter and spring enrollment.

Trustee Hadley suggested a toll-free telephone number; Mr. Clabaugh indicated the admissions office does have a toll-free line and agreed to have the telephone number advertised.

1978-80 CAPITAL BUDGET - Action

The Trustees had given telephonic approval for the 1978-80 capital budget.

00265

1978-80 CAPITAL BUDGET - Action - Continued

Motion
77-53

Mr. Flowers moved formal approval of the submission of a 1978-80 fiscal period capital budget request (attached) totalling \$807,500 from the State General Fund to correct health and safety hazards, perform emergency roof repairs, design and develop recreational facilities and remodel the library to comply with new Federal Copyright laws. Seconded by Mr. Halvorson and passed.

OTHER BUSINESS AND ANNOUNCEMENTS

Graduate Program - Discussion

Trustee Flowers asked about the graduate studies program; Mr. Kormondy reported on the need for Council for Postsecondary Education and legislative authorization, and that the college aims toward a beginning program in fall 1979.

Policy for Financial Obligation of Students - Action

Mr. Clabaugh asked the Trustees to place a revision of the policy for financial obligation of students on the agenda in order to have a public hearing at the next meeting.

Motion
77-54

Mr. Halvorson moved to place on next meeting's agenda a public hearing under the Administrative Procedures Act to consider revision to WAC 174-162-300 relating to financial obligations of students. Seconded by Mr. Berglund and passed.

Recruitment of Academic Dean - Discussion

Student Donna Hayes stated that at an affirmative action meeting she heard that the hiring process for the academic deans had not been sent to the college's affirmative action officer; President Evans indicated that he had sent the procedures to Ms. Rindy Jones some time ago.

DATE OF NEXT MEETING AND ADJOURNMENT

The date of the next meeting was set for December 8; the Trustees were reminded of the December 16 Joint Boards of Trustees meeting at the SeaTac Red Lion Motor Inn.

The meeting adjourned at 12:25 PM.

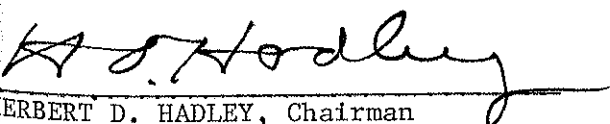
HERBERT D. HADLEY, Chairman

ROBERT J. FLOWERS, Secretary

12/8/77

12/8/77

TABLE OF CONTENTS

Goals and Objectives	1
Campus Map	5
Capital Improvement Program Summary	6
Capital Project Plans	
78-1 Emergency Renovation and Repairs.	7
78-2 College Recreation Center, Phase II	11
78-3 Develop Outdoor Recreation Field.	19
78-4 Minor Remodeling Library Building	24
Building Inventory	28
Land Inventory	31
Facility Space Classification Report	32

INTRODUCTION

00267

12/8/77

THE EVERGREEN STATE COLLEGE

CAPITAL MASTER PLAN

GOALS AND OBJECTIVES

1. To develop an academic program within a total learning environment which enables individual students to initiate a process of continuing life-long learning and personal development by:
 - preparing them with the methods of acquiring information and of experimentation;
 - encouraging independence in pursuit of inquiries that interest and motivate them;
 - giving them practice in team approaches to formulating and solving problems;
 - providing them with counsel and resources to test their knowledge and ability.
2. To tailor programs of learning to the individual so that Evergreen's graduates will tend to vary from the thoughtful specialist to the broadly-informed generalist.
3. To create an environment that responds to the student as a whole person, integrating formal education with social, physical, and emotional development.
4. To provide these programs for students of diverse ages; cultural, ethnic and economic backgrounds; interests; and outlooks who can benefit from and contribute to Evergreen's unique learning environment.
5. To provide conditions that encourage faculty members to undertake research and public service of the sort that permit students to learn by working as apprentices at the side of the faculty members.
6. To continue creating a genuine alternative among existing patterns of higher education in the State of Washington.

To support the academic program, ancillary program goals have been established:

Library - Program 05: If the student is to develop habits as a continuing learner, college experience must not be that of having been "fed" information: a student must learn to acquire most of it personally. This necessitates a strong library with as extensive a collection as possible; efficient, speedy ties to other larger collections; and -- extremely important -- a staff who see their task not simply as dispensing books but rather as helping students to find and use what they need when they need it.

Academic Computing - Program 04: Problem solvers of tomorrow need access to and capability in manipulating large quantities of information in highly sophisticated ways. Familiarity with the computer is absolutely essential. Further, the flexibility which the Evergreen program demands in the ways in which people, space, and resources are combined for particular educational purposes requires well-developed computer support for administration.

Student Services - Program 06: Activity outside the formal academic program represents a significant portion of every student's educational life at Evergreen. Providing those professional services and programs that facilitate access to the College's programs and thereby foster the student's intellectual growth and personal development entail quite diverse functions as well as participation by a broad base of involvement by members of the campus community and local citizens working on common tasks.

Administration and General Expense - Program 08: Administration is seen primarily as the deployment of the proper resources, people, funds, and materials to the right places at the right times with appropriate accumulation of data so that reports can be made outside the College and decisions can be made within it in a swift and unobtrusive fashion.

Plant Operation and Maintenance - Program 09: The State's considerable capital investment is to be maintained, protected, developed within this scale of priorities: the atmosphere for learning must be civilized, beautiful, well ordered, and achieved with such economy and naturalness that attention to the very important (simply because it can be seen and touched and is therefore an education in itself) physical environment does not divert scarce resources away from the intellectual goals -- the reasons for the College's existence.

Capital project goals that have guided the preparation of this 1979-83 Capital Master Plan and this 1978 Supplemental Capital Budget Request are as follows:

1. Emergency repairs to upgrade the lighting and ventilation systems for compliance with Safety and Health Standards and to reroof a major portion of the Library Building.
2. Recreational facilities will include a one court gymnasium with room for the martial arts mat activities and expanded locker rooms to provide comparable facilities for men and women by October, 1980.
3. Outdoor recreation fields will be developed to provide a turfed area for soccer and other field sports by January, 1979.
4. Provide a sound recording listening room for compliance with the new Copyright Law by June, 1979.
5. College Activity facilities will be expanded to accommodate the growth in enrollment to 4,500 students by expanding food service areas, student offices, lounges, bookstore and other student service facilities by October, 1982.

6. Grounds equipment storage will be built to house vehicles and grounds equipment by October, 1980. An office to serve the grounds maintenance staff will be added at the same time.
7. Funds will be made available through the capital improvement program to accommodate minor remodeling needs as they develop on a spontaneous basis to the extent of \$100,000 per biennium.

CLIENTELE DEMANDS

The Evergreen State College needs additional recreational facilities. A gymnasium is needed to provide for an indoor recreational area and additional turf area is needed for outdoor recreation. The College Recreation Center - Phase II will provide, incidentally, a facility that includes badly needed space for the performing arts.

Except for minor remodeling, there are adequate academic facilities to accommodate the institution's growth to an enrollment of 4,500 students.

CLIENT POPULATION FORECASTS (FY 1977 - FY 1985)

Year	Fall Term Total Headcount	Fall Term Day on Campus	Credit Hours	Day on Campus
	Enrollment	FTE Enrollment	per Student	Credit Hours
1977	2,540	2,204	14.0	33,060
1978	2,750	2,395	14.5	35,925
1979	2,925	2,533	14.1	37,995
1980	3,100	2,690	14.2	40,365
1981	3,300	2,850	14.1	42,780
1982	3,525	3,010	14.0	45,105
1983	3,800	3,225	13.9	48,375
1984	4,050	3,444	13.9	51,660
1985	4,320	3,662	13.9	54,930

SERVICE PROGRAM IDENTIFICATION

Recreational programs, including individual recreation, organized intramural activities and club sport activity also provide the major program justification for the second phase of the Recreation Building. Additionally, academic program use comprises a significant requirement for this type of space. Ten percent of the College's total academic instruction and study time has required gymnasium type space.

Recreational programs comprise the framework for the justification of capital needs for the playing field expansion portion of the six year capital request.

The six year capital master plan includes construction of an addition to the College Activities Building. Programs associated with student services are increasing and will, within the six year period, require additional space. In the near future, additional space will be required for the bookstore so that it can continue to meet student needs.

Operational programs related to grounds maintenance require considerable equipment that -- when not in use -- should be protected from the weather. Current limited storage space is not adequate to protect existing equipment. An inadequate trailer now being used for grounds office and lunchroom should be phased out. An office, lunchroom and locker room should be incorporated in a new equipment storage shed.

SPACE STANDARDS, EVALUATION OF ADEQUACY, REQUIREMENTS AND INVENTORY

Space standards used by The Evergreen State College follow guidelines in the Facilities Evaluation and Planning Guide (FE&PG), recently adopted by the State of Washington's four-year colleges and universities. The model consists of space evaluation procedures for each room use category identified within the Higher Education Facilities Inventory and Classification Manual (excepting health care and residential facilities). Each procedure includes definitions, data parameters, space standards and formulas (where applicable) unique to the particular room use category.

An inventory of existing space at The Evergreen State College is presented in the attached by Forms C4, C5 and C6. The evaluation of adequacy pertaining to a specific request is described in section 14 (Space Requirements) of the Project Request.

SPECIFIC PROBLEMS AND ECONOMIC FACTORS

The Evergreen State College is isolated from Olympia area recreational facilities. Evergreen students must make a round trip of approximately 15 miles to take advantage of the limited recreational facilities Olympia has to offer. This problem of isolation is compounded by several factors.

1. There is minimal public transportation between the campus and local recreational facilities.
2. Students' income is limited; they cannot afford the cost of private transportation nor admission fees into recreational facilities in the local area.
3. Energy and particularly fossil fuels are becoming more and more scarce and costly. From both the economic and environmental aspects it is not desirable to travel such a distance to the greater Olympia area.

SUMMARY OF SIX YEAR FUNDING REQUEST:

The capital budget has the following fund sources: (001) State General Fund and (252) Unexpended Plant - Local Fund.

Tuition revenues have been fully committed to facilities already constructed. Therefore, we request that all projects in the 1978-80 capital budget request be funded from the State General Fund.

The College Activities Building - Phase II will be funded from the service and activity fee through the Unexpended Plant - Local Fund.

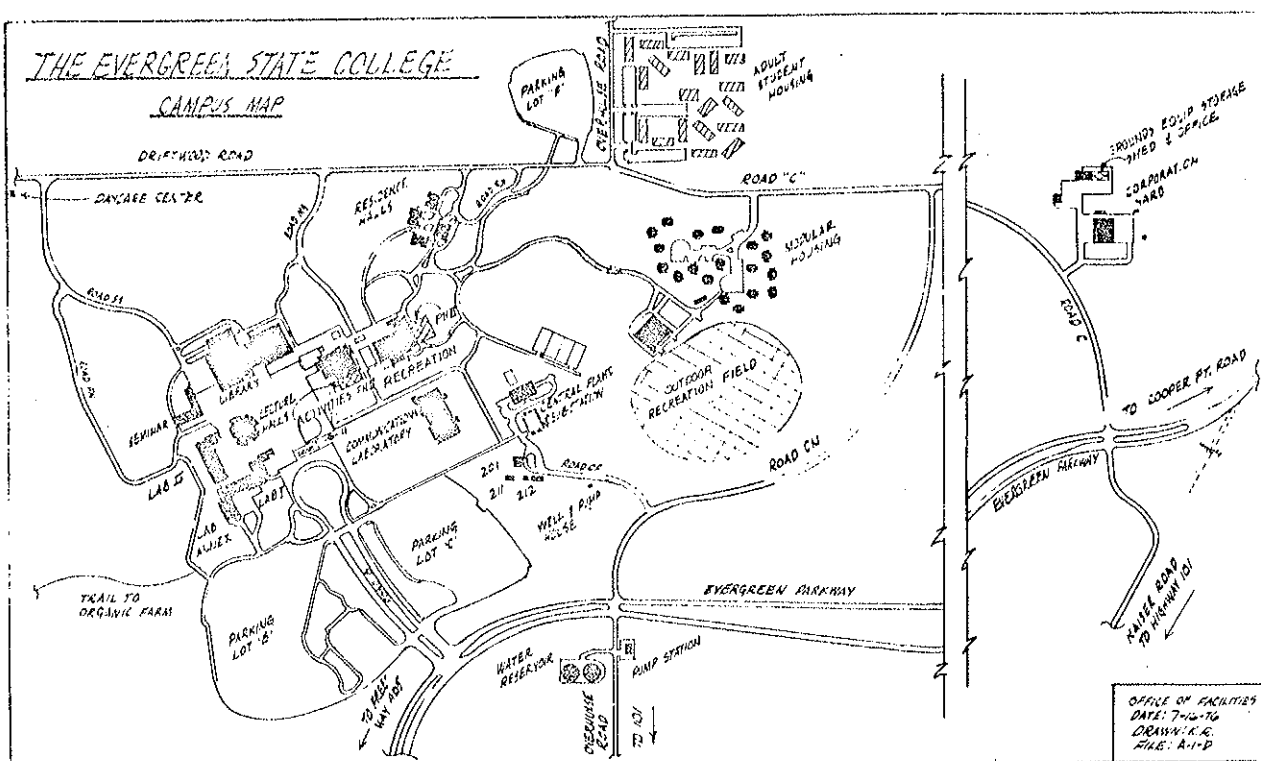

C1
State of Washington

CAPITAL IMPROVEMENT PROGRAM SUMMARY

Priority No. (3)	PROJECT TITLE AND SOURCE OF FUNDS (4)	Estimated Total Cost (5)	AGENCY NAME (1) The Evergreen State College				CODE (2) 376	
			Estimated Expenditures to June 30, 1978 (6)	1978-80 FISCAL PERIOD		1980-1982 Fiscal Period (9)	1982-1984 Fiscal Period (10)	
				Reappropriations (7)	New Appropriations (8)			
78-1	Emergency renovation and repairs, Library Building State General Fund	92,000	--	--	92,000	--	--	
78-2	College Recreation Center Phase II (Gymnasium) To provide design funds State General Fund	2,901,500	--	--	154,600	2,746,900	--	
78-3	Develop Outdoor Recreation Field State General Fund	498,800	--	--	498,800	--	--	
78-4	Minor Remodeling - Library State General Fund	62,100	--	--	62,100	--	--	
80-1	College Activities Building Phase II Local Plant	1,750,000	--	--	--	1,750,000	--	
80-2	Grounds Equipment Storage Shed State General Fund	99,500	--	--	--	99,500	--	
80-3	Minor Remodeling & Improvements State General Fund	134,000	--	--	--	134,000	--	
82-1	Minor Remodeling & Improvements State General Fund	134,000	--	--	--	--	134,000	
Fund Summary								
	State General Fund	3,921,900	--	--	807,500	2,980,400	134,000	
	Local Plant Fund	1,750,000	--	--	--	1,750,000	--	
	TOTAL	5,671,900			807,500	4,730,400	134,000	

12/8/77

12/8/77

FORM
C2
(Rev. 8/77)

STATE OF WASHINGTON
CAPITAL PROJECT REQUEST

Page 1

PROJECT TITLE (1) Emergency Renovation and Repairs - Library Building	CODE (2) 4	PRIORITY (3) 78-1	AGENCY NAME (4) The Evergreen State College	CODE (5) 376
---	---------------	----------------------	--	-----------------

LOCATION (6)

Olympia

DESCRIPTION (7)

Renovate set and model shop - provide dust tight light fixture, complete sawdust collecting system and filters for room exhaust system.

Reroof a major portion of the building roof.

BUDGET REQUEST (8)

TOTAL COST	92,000
EXPENDITURES TO JUNE 30, 1978	-0-
REAPPROPRIATION	-0-
NEW APPROPRIATION	92,000
1980-82 FISCAL PERIOD	-0-
1982-84 FISCAL PERIOD	-0-

SOURCE OF FUNDS:

State General

OFM RECOMMENDATION (9)

PROGRAM JUSTIFICATION (10)

Not applicable

78-1 EMERGENCY RENOVATION AND REPAIRS

9.10

7

9.11

DEMAND CRITERIA (11)

Set and Model Shop - this project is needed to upgrade the lighting and ventilation to comply with Safety and Health Standards.

Pereroofing - Required to prevent physical damage to the structure and interruption to academic programs. Existing rigid fiberglass insulation is saturated with water and be replaced.

ALTERNATIVES (12)

None

CURRENT UTILIZATION (13)

The set and model shop is a support facility for a number of programs and must be maintained.

00272

SPACE REQUIREMENTS (14)

Not applicable.

OPERATING IMPACT (15)

	SOURCE OF FUNDS	STAFF YEARS	SALARIES AND WAGES	OTHER OBJECTS	TOTAL COST	REVENUE
1979-81 BIENNium					-0-	
1981-83 BIENNium					-0-	
1983-85 BIENNium					-0-	

EXPLANATION

12/8/77

FORM
C3
(Rev. 8/77)

STATE OF WASHINGTON
CAPITAL PROJECT TECHNICAL SUMMARY

PROJECT TITLE (1) Emergency Renovation and Repairs - Library Building		CODE (2) 4	PRIORITY (3) 78-1	AGENCY NAME (4) The Evergreen State College	CODE (5) 376
BUDGET ESTIMATE (6)			AGENCY COMMENTS (7)		
ELEMENT	BASE COST	INFLATION ALLOWANCE	ADJUSTED COST		
<p>A. LAND</p> <p>\$ --- % \$ ---</p>					
<p>B. DESIGN</p> <p>ARCH/ENGR FEES \$ ---</p> <p>COSTS INCIDENTAL TO CONSTR. \$ ---</p> <p>TOTAL \$ --- % \$ ---</p>					
<p>C. BUILDING</p> <p>WORK \$ ---</p> <p>INGS \$ 79,500</p> <p>CONTRACTS \$ ---</p> <p>CONTINGENCY \$ ---</p> <p>% SALES TAX \$ 4,100</p> <p>TOTAL \$ 83,600 10 % \$ 92,000</p>					
<p>D. EQUIPMENT</p> <p>EQUIPMENT \$ ---</p> <p>% SALES TAX \$ ---</p> <p>TOTAL \$ --- % \$ ---</p>					
<p>E. MISCELLANEOUS</p> <p>ARTWORK (1% of 1% of C) \$ ---</p> <p>OTHER (Explain under Agency Comments) \$ ---</p> <p>TOTAL \$ --- % \$ ---</p> <p>GRAND TOTAL \$ 80,000 --- % \$ 92,000</p> <p>UNIT COST \$ ---</p>					
PROJECT STATISTICS (8)			PROJECT SCHEDULE (9)		
ENCLOSED GROSS AREA	---	SQ. FT.	LAND ACQUISITION	START	COMPLETE
NET ASSIGNABLE AREA	---	SQ. FT.	PRELIMINARY DESIGN	---	---
EFFICIENCY	---	%	DESIGN DEVELOPMENT	---	---
NON ASSIGNABLE AREA	---	SQ. FT.	WORKING DRAWINGS	---	---
TOTAL ADJUSTED AREA	---	SQ. FT.	BIDDING	---	---
			CONSTRUCTION	8/1/78	12/1/78
ANALYSIS (For OEM Use Only)					
PROJECT CODES			(See Instructions)		
<p>1. EMERGENCY REPAIR</p> <p>2. CODE REQUIREMENT</p> <p>3. HANDICAP ACCESS</p> <p>4. MINOR RENOVATION</p>			<p>5. MAJOR RENOVATION</p> <p>6. ENERGY CONSERVATION</p> <p>7. NEW CONSTRUCTION</p> <p>8. EQUIPPING</p>		
			<p>9. LAND ACQUISITION</p> <p>10. SITE IMPROVEMENTS</p> <p>11. OTHER</p>		

78-2 COLLEGE RECREATION CENTER, PHASE II

00273

12/8/77

FORM C2
(Rev. 5/77)

STATE OF WASHINGTON
CAPITAL PROJECT REQUEST

Page 1

PROJECT TITLE (1) College Recreation Center Phase II (Gymnasium) CODE (2) 7/4 PRIORITY (3) 78-2 AGENCY NAME (4) The Evergreen State College CODE (5) 376

LOCATION (6)
Olympia

DESCRIPTION (7)
One full size court on upper level, interchangeable to two secondary courts. Space for martial arts, mat activities and locker room expansion on the lower level. Remodel existing locker rooms to provide comparable facilities for men and women to comply with Title IX requirements.

BUDGET REQUEST (8)

TOTAL COST	2,901,500
EXPENDITURES TO JUNE 30, 1978	-0-
REAPPROPRIATION	-0-
NEW APPROPRIATION	154,600
1980-82 FISCAL PERIOD	2,746,900
1982-84 FISCAL PERIOD	-0-
SOURCE OF FUNDS:	

UPM RECOMMENDATION (9)

PROGRAM JUSTIFICATION (10)

Interior recreational programs, including individual recreation, organized intramural activities and club sport activity provide the major program justification for the second phase of the Recreation Building. Additionally, academic program use comprises a significant requirement for this type of space; in the six year history of the college, ten percent of the total academic instruction and study time has required a gymnasium.

The facility will provide an integral part of the college's educational apparatus in addition to providing a space for physical activity.

Phase II will be an addition to the existing building. The existing locker and shower rooms will serve the new and existing phase of the building with minor modification. To comply with Title IX requirements, it will be necessary to remodel the existing locker rooms and also expand them into Phase II. Title IX requires that comparable facilities be provided for men and women.

We are requesting only design funds at this time.

9.16

FORM C2

Page 2

DEMAND CRITERIA (11)

The Evergreen State College needs a gymnasium facility to provide indoor recreational space. The College Recreation Center Phase II will, incidentally, provide a badly needed space for academic programs, which include: performing arts, Pacific Rim studies (martial arts), recreation and recreation management, Multi-Media production, and health science programs. It will also include assembly space for events like graduation that require seating capacity in excess of two thousand. Current facilities are inadequate to meet this demand.

It is also necessary to remodel the existing locker rooms to provide comparable facilities for men and women to comply with Title IX requirements.

ALTERNATIVES (12)

1. Convert existing covered recreation pavilion - this alternative would require extensive remodeling to a wood frame roof structure with open sides that cover two tennis courts. Net assignable area 16,350 sq. ft. Estimated cost if bid in June 1979 is \$2,069,000. New locker/shower/equipment rooms and fire sprinkler system required, also steam, condensate and electrical utility extensions required. Disadvantages - loss of tennis courts, duplication of support facilities (locker/shower/equipment room), very remote from existing parking lots and campus core.
2. Phase II Alternative - one full size court on ground level, interchangeable to two secondary courts, for gross area of 22,780 sq. ft. Estimated cost if bid in June 1979 is \$2,161,400. With this alternative, only 80% of calculated entitlement is provided. This alternative would provide the necessary large open space for basketball, volleyball, etc., but because of the elimination of the mat space, we would have to give up important functions related to academic programs and most sports. A one floor addition will not provide a complete facility and desirable separation for the various programs.

FORM C2 (Rev. 5/77)

9.17

12/8/77

CURRENT UTILIZATION (13)

Space standards used by The Evergreen State College follow guidelines in the Facilities Evaluation and Planning Guide (FE & PG), recently adopted by the State of Washington's four-year colleges and universities. The model consists of space evaluation procedures for each room use category identified within the Higher Education Facilities Inventory and Classification Manual (excepting health care and residential facilities). Each procedure includes definitions, data parameters, space standards and formulas (where applicable) unique to the particular room use category.

SPACE REQUIREMENTS (14)

The new facility will add 28,260 assignable square feet (ASF).

When considering a structure like a gymnasium, although this request is not predicated on enrollment growth, it is reasonable to base formulated need on the student capacity of the existing facilities (4,000 to 5,000 students).

Our 1977-79 capital budget request and area justification related to the gymnasium used as a base 4,008 students and 481 faculty and staff. The same criteria are used.

Refer to the following page for space analysis.

OPERATING IMPACT (15)

	SOURCE OF FUNDS	STAFF YEARS	SALARIES AND WAGES	OTHER OBJECTS	TOTAL COST	REVENUE
1979-81 BIENNIAL		1.83	12,846	22,903	35,749	
1981-83 BIENNIAL		1.83	33,751	61,934	95,685	
1983-85 BIENNIAL		1.83	35,595	69,771	105,366	

EXPLANATION

COLLEGE RECREATION CENTER - PHASE II (Gymnasium) Space Analysis

In the category of Athletic Physical Education and Recreation, we will provide an overview of the adequacy/inadequacy of existing space in the applicable category.

Athletic/Physical Education (Room Types 520, 523, 525) and Recreation (Room Types 670, 675)

Although gymnasium handball courts and swimming pools are treated under instructional laboratories, they actually serve more than one function in an institution. In addition to fulfilling the instructional laboratory requirements, they may also serve as recreational facilities for students, faculty and staff. In an institution such as The Evergreen State College, where instruction and recreation are combined, we must count them both as instructional laboratories and recreational facilities. Formula calls for:

12.1 square feet of indoor activity area and service for each undergraduate student

12.1 square feet of indoor activity area for 15% of the faculty and staff

Actual Physical Education and Recreation space available with a gymnasium:

A. Actual Space available:

1. Present inventory (November, 1977)	44,864 ASF
2. Requested project 78-2, College Recreation Center Phase II	28,260 ASF
TOTAL	73,124 ASF *

* (includes inadequate or substandard space)

B. Formulated need for Physical Education and Recreation space based on 4,008 students:

1. Undergraduate 12.1 x 4,008	48,487 ASF
2. Faculty and staff 12.1 x 481 x .15	873 ASF
TOTAL	49,370 ASF

Physical Education and Recreation space status is 23,754 ASF over formula entitlement. However, the following analysis of the existing Physical Education and Recreational facilities identifies the inadequacy of certain existing space included in the Athletic/Physical Education and Recreation category and justifies our request for a gymnasium.

Central Utility Plant Gym - Located in one corner of the boiler room in the space which will eventually house the College's second boiler. It consists of two basketball backboards mounted on structural columns. A concrete floor the size of approximately one half a basketball court has structural columns in the shooting area. The area is also used for volleyball. A mat area for martial arts and gymnastics is located to one side. Heating and ventilation do not meet health standards.

12/8/77

College Recreation Center, Phase I - Consists of five handball courts, men's and women's weight training rooms, swimming pool and diving bowl, saunas, service area (lockers, laundry, etc.).

Covered Recreation Pavilion - Has two asphalt surfaced tennis courts with basketball backboards and is located adjacent to the modular housing area. The structure is unheated and has open sides. Primarily, this building provides cover for the tennis courts. The structure does not have shower and locker rooms.

College Activities Building, Phase I - Has space for one ping pong table, billiards and related storage.

Daniel J. Evans Library - Contains an area for studio arts.

Summary of Existing P.E. & Recreation Space	Inadequate	Adequate
Central Utility Plant	3,767	
College Recreation Center, Phase I		20,489
Covered Recreation Pavilion	17,534	
College Activities Building, Phase I	2,095	
Daniel J. Evans Library		979
TOTAL	21,301 ASF	23,563 ASF
Adequate Indoor Recreation Facilities		23,563 ASF
With requested project 78-2, College Recreation Center, Phase II		28,260 ASF
TOTAL		51,823 ASF
Formula Entitlement		49,370 ASF
Over Formula Entitlement		2,453 ASF

FORM C3 (Rev. 8/77)		STATE OF WASHINGTON CAPITAL PROJECT TECHNICAL SUMMARY			
PROJECT TITLE (1): College Recreation Center Phase II (Gymnasium)		CODE (2): 7/4	PRIORITY (3): 78-2	AGENCY NAME (4): The Evergreen State College	CODE (5): 376
BUDGET ESTIMATE (6)					AGENCY COMMENTS (7): One full size court on upper level (175') Martial arts, mat activities and locker room expansion on lower level (160') To comply with Title IX requirements it will be necessary to remodel the existing locker rooms and also expand the locker rooms into Phase II to provide comparable facilities for men and women. Base construction costs: Upper Level, 18,600 s.f. at \$61.50/s.f. Lower Level, 16,664 s.f. at \$40.00/s.f. *Cost to remodel existing locker rooms is 2930 s.f. x \$35 = \$102,550 plus tax
ELEMENT	BASE COST	INFLATION ALLOWANCE	ADJUSTED COST		
A. LAND	\$ ---	---%	\$ ---		
B. DESIGN					
ARCH/ENGR FEES	\$ 138,000	(through working drawing phase)			
COSTS INCIDENTAL TO CONSTR.	\$ ---				
TOTAL	\$ 138,000	12%	\$ 154,600		
C. BUILDING					
SITE WORK	\$ 70,000				
BUILDINGS	\$ 1,809,500				
OTHER CONTRACTS	\$ 7,500	(Air/Water Balancing)			
CONTINGENCY (5%)	\$ 94,400				
5.1 % SALES TAX	\$ 101,100				
TOTAL	\$ 2,082,500	17%	\$ 2,436,500		
D. EQUIPMENT					
EQUIPMENT	\$ 144,500				
5.1 % SALES TAX	\$ 7,400				
TOTAL	\$ 151,900	21%	\$ 183,800		
E. MISCELLANEOUS					
ARTWORK (1% of 1% of C)	\$ 10,400				
OTHER (Explain under Agency Comments)	\$ 107,800	w/tax			
TOTAL	\$ 108,200	17%	\$ 126,600		
GRAND TOTAL	\$ 2,480,600	17%	\$ 2,901,500		
UNIT COST	\$ 70.34		\$ 82.28		
PROJECT STATISTICS (8)			PROJECT SCHEDULE (9)		
ENCLOSED GROSS AREA	35,264	SQ. FT.	LAND ACQUISITION	START	COMPLETE
NET ASSIGNABLE AREA	28,260	SQ. FT.	PRELIMINARY DESIGN	9/1/78	11/1/78
EFFICIENCY	80.14	%	DESIGN DEVELOPMENT	11/1/78	2/1/79
NON ASSIGNABLE AREA	7,004	SQ. FT.	WORKING DRAWINGS	2/1/79	9/1/79
TOTAL ADJUSTED AREA		SQ. FT.	BIDDING	8/1/79	9/1/79
			CONSTRUCTION	9/1/79	10/1/80
ANALYSIS (For OFM Use Only)					
(1) See Appendix A, Part III of the Instructions for the appropriate inflation allowance factor. Select the inflation rate corresponding to the closest quarter to the estimated start schedule for bidding as shown on the project building schedule.			PROJECT CODES (See Instructions)		
			1. EMERGENCY REPAIR 5. MAJOR RENOVATION 9. LAND ACQUISITION 2. CODE REQUIREMENT 6. ENERGY CONSERVATION 10. SITE IMPROVEMENTS 3. HANDICAP ACCESS 7. NEW CONSTRUCTION 11. OTHER 4. MINOR RENOVATION 8. EQUIPPING		

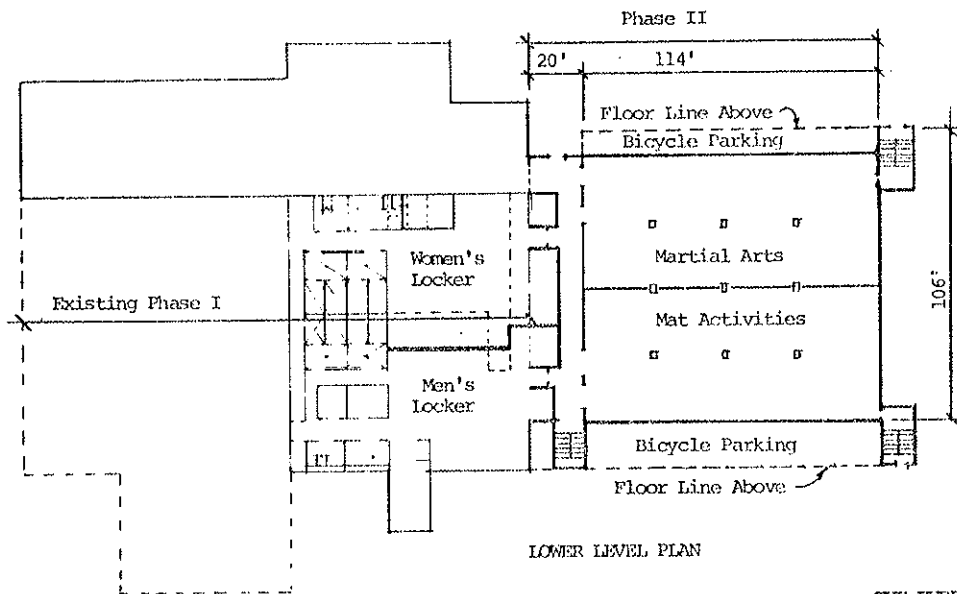

LOWER LEVEL PLAN

THE EVERGREEN STATE COLLEGE
Project 78-2
College Recreation Center
Phase II Gymnasium
10/77

SPACE FOR:
One primary basketball court (94' x 50')
Two secondary basketball courts (86' x 44')
Three volleyball courts (60' x 30')
Six badminton courts (44' x 20')

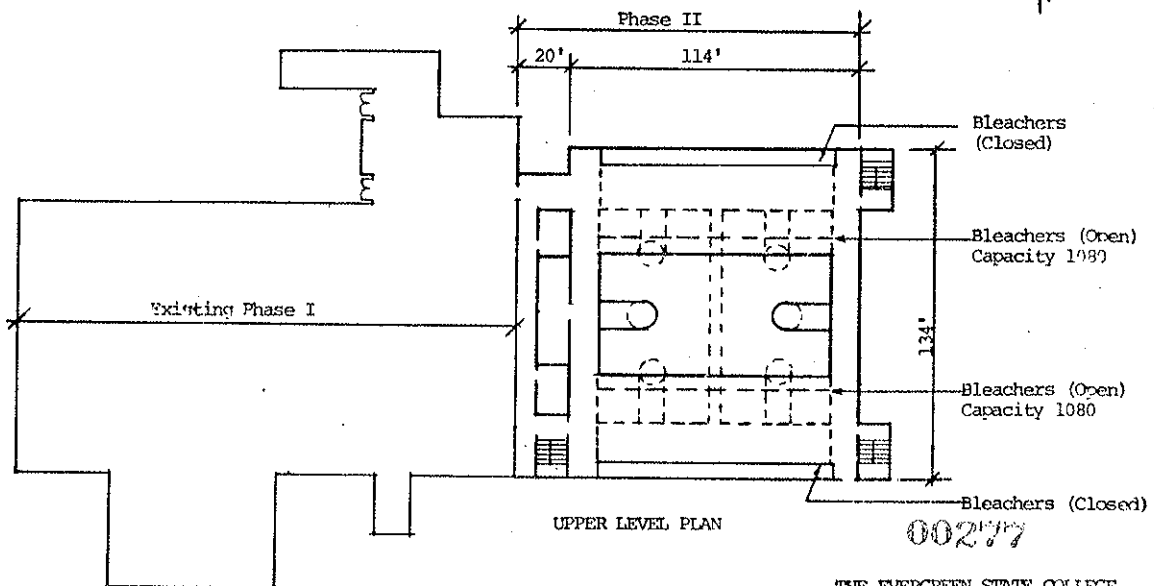

UPPER LEVEL PLAN

THE EVERGREEN STATE COLLEGE
Project 78-2
College Recreation Center
Phase II Gymnasium
10/77

12/8/77

12/8/77

FORM
C2
(Rev. 8/77)STATE OF WASHINGTON
CAPITAL PROJECT REQUEST

Page

PROJECT TITLE (1) Recreation Field		CODE (2) 7	PRIORITY (3) 78-3	AGENCY NAME (4) The Evergreen State College	CODE (5) 376
LOCATION (6) Olympia					
DESCRIPTION (7) Develop an existing 9.5 acre cleared area to provide a soccer/football field and softball field. The 400 meter track, field event facilities, restrooms and storage building and bleachers shown on the Master Plan will be constructed in the future.					
BUDGET REQUEST (8)				OFM RECOMMENDATION (9)	
TOTAL COST				498,800	
EXPENDITURES TO JUNE 30, 1978				---	
REAPPROPRIATION				---	
NEW APPROPRIATION				498,800	
1980-82 FISCAL PERIOD				---	
1982-84 FISCAL PERIOD				---	
SOURCE OF FUNDS:				State General	

78-3 DEVELOP OUTDOOR RECREATION FIELD

PROGRAM JUSTIFICATION (10)

Continuing and expanding recreational programs comprise the framework for the justification for further development of land set aside for recreational use.

Running, jogging, soccer and softball have become a national outdoor recreation activity for those students, faculty and staff members who are interested in keeping physically fit; this project will provide the necessary facility.

9.24

9.25

12/8/77

Page

DEMAND CRITERIA (11)

The capacity of the present recreation field is approximately fifty participants at any one time. Generally only one or, at the most, two activities can now function simultaneously. This restricted capacity did not begin to meet the needs of the initial enrollment. It cannot possibly handle the numerous activities such as flag football, soccer, softball, rugby, track and field, and field hockey which will accompany an enrollment of approximately 3,500 students.

ALTERNATIVES (12)

There are no suitable alternatives for a field location.

Construction is phased for the Master Plan. The first phase of the Master Plan provides a soccer/football field and a softball field that comprises this request. The second phase will consist of a 400 meter track, field event facilities, restrooms and storage building and bleachers.

9.26

FORM C2

CURRENT UTILIZATION (13)

Refer to page 1

00279

SPACE REQUIREMENTS (14)

Not applicable

OPERATING IMPACT (15)

	SOURCE OF FUNDS	STAFF YEARS	SALARIES AND WAGES	OTHER OBJECTS	TOTAL COST	REVENUE
1979-81 BIENNium		1.50	\$16,884	\$8,011	\$24,895	
1981-83 BIENNium		1.50	\$17,961	\$8,450	\$26,411	
1983-85 BIENNium		1.50	\$19,830	\$9,278	\$29,108	

EXPLANATION

9.27

12/8/77

FORM C3 STATE OF WASHINGTON
CAPITAL PROJECT TECHNICAL SUMMARY

PROJECT TITLE (1) Develop Outdoor Recreation Field		CODE (2) 7	PRIORITY (3) 78-3	AGENCY NAME (4) The Evergreen State College	CODE (5) 376
BUDGET ESTIMATE (6)					
ELEMENT	BASE COST	INFLATION ALLOWANCE	ADJUSTED COST		
A. LAND	\$ ---	---%	\$ ---		
B. DESIGN					
ARCH/ENGR FEES	\$ 29,600				
COSTS INCIDENTAL TO CONSTR.	\$ 6,500				
TOTAL	\$ 36,100	12%	\$ 40,400		
C. CONSTRUCTION					
WORK	\$ 370,000				
FININGS	\$ NA				
OTHER CONTRACTS	\$ NA				
CONTINGENCY (5%)	\$ 18,500				
5.1% SALES TAX	\$ 18,900				
TOTAL	\$ 407,400	12%	\$ 456,200		
D. EQUIPMENT					
EQUIPMENT	\$ ---				
% SALES TAX	\$ ---				
TOTAL	\$ -0-	%	\$ -0-		
E. MISCELLANEOUS					
ARTWORK (1% of 1% of C)	\$ 2,000				
OTHER (Explain under Agency Comments)	\$ ---				
TOTAL	\$ 2,000	12%	\$ 2,200		
GRAND TOTAL	\$ 445,500	%	\$ 498,600		
UNIT COST	\$ NA		\$ NA		

This request provides a soccer and softball field and jogging trails. The 400 meter track, field event facilities, restrooms and storage building and bleachers shown on the Master Plan will be constructed in the future; their cost is not included in this summary.

PROJECT STATISTICS (8)			PROJECT SCHEDULE (9)	
Area - 9.5 acres			START	COMPLETE
ENCLOSED GROSS AREA	NA	SQ. FT.	LAND ACQUISITION	5/1/78
NET ASSIGNABLE AREA	NA	SQ. FT.	PRELIMINARY DESIGN	6/1/78
EFFICIENCY	NA	%	DESIGN DEVELOPMENT	7/1/78
NON ASSIGNABLE AREA	NA	SQ. FT.	WORKING DRAWINGS	8/1/78
TOTAL ADJUSTED AREA	NA	SQ. FT.	BIDDING	9/1/78
			CONSTRUCTION	1/1/79

ANALYSIS (For OFM Use Only)

Appendix A, Part III of the Instructions for the appropriate inflation allowance factor. Select the inflation rate corresponding to the closest quarter to the estimated start schedule for bidding as shown on the project building schedule.

PROJECT CODES

- | | | |
|---------------------|------------------------|-----------------------|
| 1. EMERGENCY REPAIR | 5. MAJOR RENOVATION | 9. LAND ACQUISITION |
| 2. CODE REQUIREMENT | 6. ENERGY CONSERVATION | 10. SITE IMPROVEMENTS |
| 3. HANDICAP ACCESS | 7. NEW CONSTRUCTION | 11. OTHER |
| 4. MINOR RENOVATION | 8. EQUIPPING | |

(See Instructions)

9.28

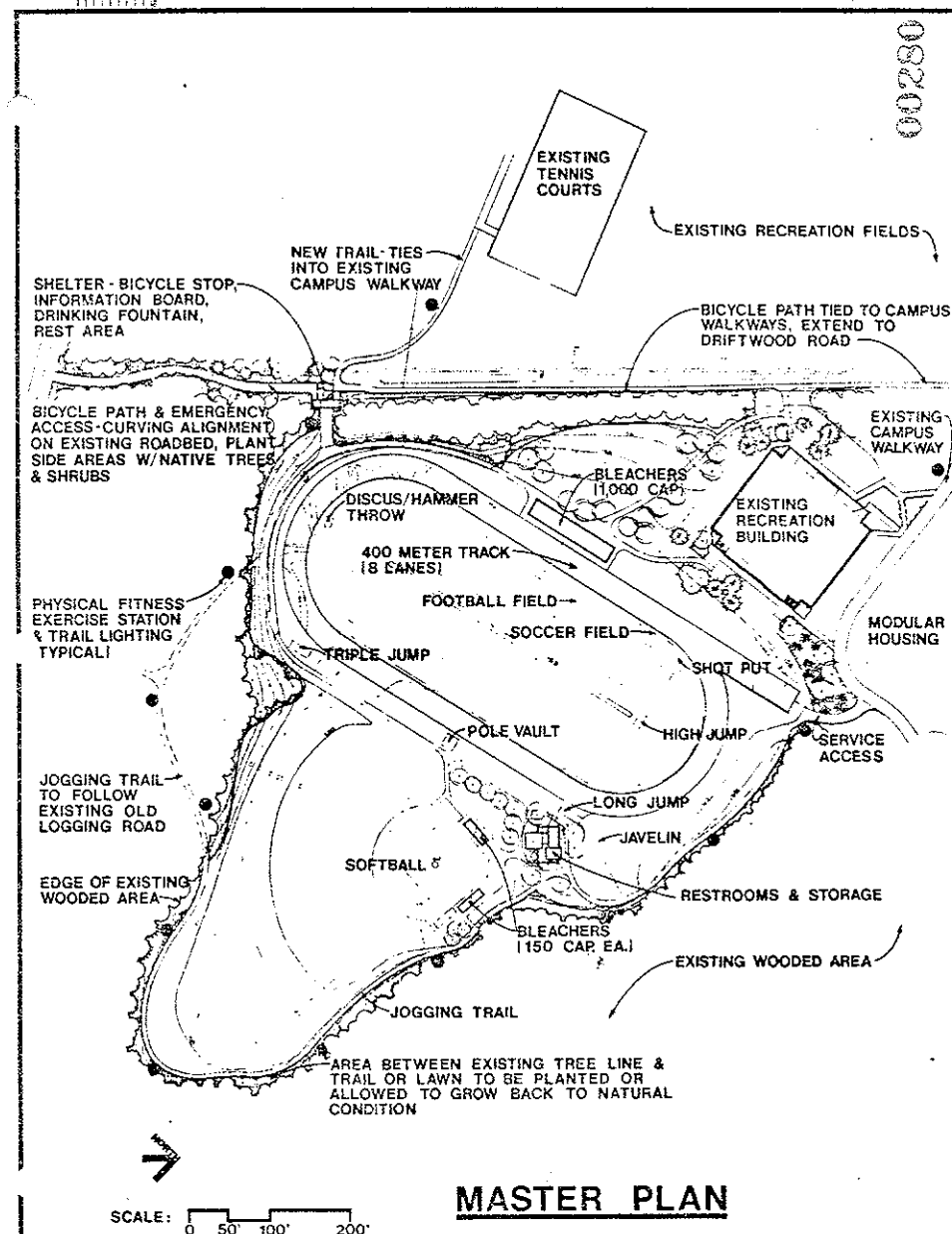

MASTER PLAN

RECREATION FIELD ADDITION & IMPROVEMENTS
THE EVERGREEN STATE COLLEGE OLYMPIA, WASH.
THE ORB ORGANIZATION
Project Building, 300 1st St., North, Olympia, WA 98501. Tel: 360-221-1122

12/8/77

FORM
C2
(Rev. 8/77)STATE OF WASHINGTON
CAPITAL PROJECT REQUEST

Page 1

PROJECT TITLE (1) Minor Remodelling - Library	CODE (2) 4	PRIORITY (3) 78-4	AGENCY NAME (4) The Evergreen State College	CODE (5) 376
LOCATION (6) Olympia				
DESCRIPTION (7) <ol style="list-style-type: none"> 1. Remodel Library Room 3305 to provide for a sound recording listening facility. 2. Provide shelving and cabinets. 				
BUDGET REQUEST (8)			OFM RECOMMENDATION (9)	
TOTAL COST 62,100 EXPENDITURES TO JUNE 30, 1978 --- REAPPROPRIATION --- NEW APPROPRIATION 62,100 1980-82 FISCAL PERIOD --- 1982-84 FISCAL PERIOD --- SOURCE OF FUNDS: 				

78-4 MINOR REMODELING LIBRARY BUILDING

PROGRAM JUSTIFICATION (10)

The Evergreen State College Library has provided access to its sound recording collection by dubbing the discs onto cassette tapes which circulate to users. Under the provisions of the New Copyright Law, we will have to discontinue duplicating and circulating cassettes. A sound recording listening facility will be necessary. The facility will need to have individual and group listening capabilities.

The non comparable/one time shelving and cabinet equipment request will meet the reference storage needs for the foreseeable future and will be placed in existing library space. The Reference area is expanding at a rate of approximately 1,500 new volumes per year. The existing steel shelving is full with 8,000 volumes; we have no further shelving capability in the reference area. The request for shelving will provide space for approximately 4.5 years of new reference acquisitions.

9.30

9.31

12/8/77

DEMAND CRITERIA (11)

Library Area - The reference area presently houses 9,000 units of materials. By 1980, the size of the reference collection will be approximately 13,000 units. The sound recording listening facility will house 8,000 disc recordings currently on hand.

ALTERNATIVES (12)

1. Store reference materials in boxes in basement storage area.
2. Provide a very limited sound recording listening space.

9.32

CURRENT UTILIZATION (13)

The reference area is currently at a maximum utilization capacity including the use of study stations for storage of materials. The audio cassette collection is heavily used by students and faculty. Circulation figures for the 1976-77 academic year were:

September	279
October	643
November	487
December	347
January	768
February	464
March	371
April	497
May	323
June	184

SPACE REQUIREMENTS (14)

An area of 1,666 square feet is needed for the sound recording listening facility.

OPERATING IMPACT (15)

	SOURCE OF FUNDS	STAFF YEARS	SALARIES AND WAGES	OTHER OBJECTS	TOTAL COST	REVENUE
1979-81 BIENNIAL		1.00	15,672	400.00	16,072	
1981-83 BIENNIAL		1.00	17,304	420.00	17,724	
1983-85 BIENNIAL		1.00	19,104	441.00	19,545	

EXPLANATION

One Media Services Operator for sound recording listening facility.

9.33

12/8/77

FORM C3 STATE OF WASHINGTON
CAPITAL PROJECT TECHNICAL SUMMARY

PROJECT TITLE (1) Minor Remodelling - Library		CODE (2) 4	PRIORITY (3) 78-4	AGENCY NAME (4) The Evergreen State College	CODE (5) 376
BUDGET ESTIMATE (6)		INFLATION ALLOWANCE		AGENCY COMMENTS (7)	
ELEMENT	BASE COST				
A. LAND	\$ —	— %	\$ —		
B. DESIGN					
ARCH/ENGR FEES	\$ —				
COSTS INCIDENTAL TO CONSTR.	\$ —				
TOTAL	\$ —	— %	\$ —		
C. BUILDING					
WORK	\$ NA				
AGS	\$ —				
CONTRACTS	\$ 5,000				
CONTINGENCY	\$ 500				
SALES TAX	\$ 300				
TOTAL	\$ 5,800	17 %	\$ 6,800		
D. EQUIPMENT					
EQUIPMENT	\$ 45,000				
SALES TAX	\$ 2,300				
TOTAL	\$ 47,300	17 %	\$ 55,300		
E. MISCELLANEOUS					
ARTWORK (1% of 1% of C)	\$ NA				
OTHER (Explain under Agency Comments)	\$ —				
TOTAL	\$ —	— %	\$ —		
GRAND TOTAL	\$ 53,100	— %	\$ 62,100		
UNIT COST	\$ NA		\$ NA		
PROJECT STATISTICS (8)		PROJECT SCHEDULE (9)			
ENCLOSED GROSS AREA	— SQ. FT.	LAND ACQUISITION	START	COMPLETE	
NET ASSIGNABLE AREA	— SQ. FT.	PRELIMINARY DESIGN	9/1/78	11/1/78	
EFFICIENCY	— %	DESIGN DEVELOPMENT	11/1/78	12/1/78	
NON ASSIGNABLE AREA	— SQ. FT.	WORKING DRAWINGS	12/1/78	2/1/79	
TOTAL ADJUSTED AREA	— SQ. FT.	BIDDING	2/1/79	3/1/79	
		CONSTRUCTION	3/1/79	6/1/79	
ANALYSIS (For OFM Use Only)					
PROJECT CODES (See Instructions)					
1. EMERGENCY REPAIR		5. MAJOR RENOVATION			
2. CODE REQUIREMENT		6. ENERGY CONSERVATION			
3. HANDICAP ACCESS		7. NEW CONSTRUCTION			
4. MINOR RENOVATION		8. EQUIPPING			
		9. LAND ACQUISITION			
		10. SITE IMPROVEMENTS			
		11. OTHER			
		9.34			

00283

BUILDING INVENTORY

9.35

BUILDING INVENTORY

State of Washington		AGENCY		Code (1)		Title (2)	
Program (3)		376		The Evergreen State College			
Instruction		Date of Inventory (4)		October 1977		Page 1 of 3 Pages (5)	

Name (6)	Location (7)	Year of Construction (8)	Year of Last Renovation (9)	Type of Construction (10)	Condition (11)	Enclosed Gross Area or Volume (12)	Net Assignable Area (13)
Daniel J. Evans Library (1)	Olympia	1971		3	1	334,824	214,551
Lecture Halls (2)		1972		3		28,300	13,903
College Recreation Center (3)		1973				56,701	25,992
Laboratory Building, Ph. I (4)		1973				83,976	46,722
Laboratory Annex (4a)		1973				11,302	8,532
Central Utility Plant (5)		1971				26,255	7,000
Shop & Shop Addition (6)		1972				13,948	10,888
Garage (7)		1971				1,494	1,287
Water Pump Station (8)		1970				2,141	0
Covered Recreation Pavilion (9)		1973				18,382	17,534
President's Residence (10)		1969	1970	1		5,559	5,095
Seminar Building (11)		1974		3		41,197	20,912
Science Laboratory, Ph. II (12)		1975				83,649	49,171
Combustible Storage Bldg. (13)		1974		1		608	559
Communications Lab. (14)		1977		3	1	84,199	41,929

TYPE OF CONSTRUCTION: (See Instructions)

1. Wood & Metal Stud Construction
2. Masonry
3. Reinforced Concrete Fireproof
4. Structural Steel Frame Fireproof

CONDITION: (See Instructions)

1. Satisfactory
2. Remodeling--A
3. Remodeling--B
4. Remodeling--C
5. Demolition
6. Termination

BUILDING INVENTORY

C 4 State of Washington		AGENCY		Code (1)		Title (2)	
Program (3)		376		The Evergreen State College			
Instruction		Date of Inventory (4)		October 1977		Page 2 of 3 Pages (5)	

Name (6)	Location (7)	Year of Construction (8)	Year of Last Renovation (9)	Type of Construction (10)	Condition (11)	Enclosed Gross Area or Volume (12)	Net Assignable Area (13)
College Activities Bldg. (101)	Olympia	1972		3	1	78,091	40,636
Residence Hall A (102)		1972				46,377	29,324
Residence Hall B (103)		1972				20,588	14,725
Residence Hall C (104)		1972				20,547	14,678
Residence Hall D (105)		1972				20,547	14,756
Temporary Office Bldg. (201)		1969	1969			3,063	2,285
Grounds Office Trailer (202)		1969				550	476
Marine Lab West (204)		1969				3,522	2,950
Driftwood Day Care Center (205)		1969	1975			1,344	1,223
Organic Farm (206)		1969			5	1,155	1,054
Well House (210)		1969			1	59	-
Temporary Art Studio (211)		1970				2,045	1,803
Fire Station (212)		1970				2,918	2,406
Temporary Fire Station Garage (213)		1971				980	948
Fire Station Apparatus Room (214)		1972				812	747

TYPE OF CONSTRUCTION: (See Instructions)

1. Wood & Metal Stud Construction
2. Masonry
3. Reinforced Concrete Fireproof
4. Structural Steel Frame Fireproof

CONDITION: (See Instructions)

1. Satisfactory
2. Remodeling--A
3. Remodeling--B
4. Remodeling--C
5. Demolition
6. Termination

BUILDING INVENTORY

State of Washington		AGENCY	Code (1)	The Evergreen State College	
Program (3)	Instruction	Date of Inventory (4)		Page 3 of 3	Pages 151
		October 1977			

Name (6)	Location (7)	Year of Construction (8)	Year of Last Renovation (9)	Type of Construction (10)	Condition (11)	Enclosed Gross Area or Volume (12)	Net Assignable Area (13)
Vehicle & Equip. Storage (215)	Olympia	1975		4	1	1,800	1,750
Grounds Storage Gr. (216)		1969		1		64	52
Grounds Storage Wh. (217)		1971				384	352
Marine Lab East (218)		1973				3,751	3,068
Modular Housing (300-318)		1971				30,096	27,436
Modular Housing Laundry(319)		1971				448	412
Utility Tunnel & Substation		1971		3		43,162	---
TOTAL						1,074,838	625,156

<u>TYPE OF CONSTRUCTION:</u> 1. Wood & Metal Stud Construction 2. Masonry (See Instructions)		3. Reinforced Concrete Fireproof 4. Structural Steel Frame Fireproof (See Instructions)	
<u>CONDITION:</u> 1. Satisfactory 2. Remodeling--A (See Instructions)		3. Remodeling--B 4. Remodeling--C 5. Demolition 6. Termination (See Instructions)	

LAND INVENTORY

00285

12/8/77

LAND INVENTORY

of Washington		AGENCY	Code (1)	17	Evergreen State College	
Program (3)		376		Date of Inventory (4)	October 1977	
				Page 1	of 1	Pages (5)

Name (6)	Location (7)	Year of Acquisition (8)	Acres or Footage (9)	Percent Developed (10)	Improvements (11)
The Evergreen State College	Olympia, Washington	1969	1,000 acres	19.76	See Building Inventory on Form C-4

FACILITY SPACE CLASSIFICATION REPORT

12/8/77

00286

FACILITY SPACE CLASSIFICATION REPORT

of Washington		AGENCY	Code (1)	Title (2)		
			376	Evergreen State College		
Program (3)		Date of Inventory (4)		Page		(5)
Instruction		October 1977		1 of 4		Pages

Code (6)	Name (7)	SPACE CLASSIFICATION (Room or Use Type) (8)					Total Area (9)
		100 Classroom	200 Laboratory	300 Office	400 Study	500 Special Use	
1	Daniel J. Evans Library	26,400	15,114	39,560	47,487	34,942	(cont'd on page 2)
2	Lecture Halls	12,778	--	176	--	--	
3	College Recreation Center	899	3,357	1,197	--	20,343	
4	Laboratory Building, Phase I	--	26,391	11,466	--	1,129	
4A	Laboratory Annex	--	6,651	--	--	1,881	
5	Central Utility Plant	--	--	104	--	3,767	
6	Shop & Shop Addition	--	--	285	--	--	
7	Garage	--	--	93	--	--	
8	Water Pump Station	--	--	--	--	--	
9	Covered Recreation Pavilion	--	--	--	--	17,534	
10	President's Residence	--	--	--	--	--	
11	Seminar Building	1,792	3,527	11,289	--	--	
12	Science Laboratory, Phase II	4,747	31,615	12,016	--	--	
13	Combustible Storage Building	--	--	--	--	--	
14	Communications Laboratory	3,509	32,667	3,425	1,528	--	
16	Utility Tunnel & Substation	--	--	--	--	--	
101	College Activities Building	--	--	4,350	--	899	
102	Residence Hall "A"	--	--	979	--	--	
103	Residence Hall "B"	--	--	--	--	--	
104	Residence Hall "C"	--	--	--	--	--	
105	Residence Hall "D"	--	--	--	--	--	
201	Temporary Office Building	--	--	--	--	--	
202	Grounds Office Trailer	--	--	476	--	--	
204	Marine Lab West	--	1,030	108	--	--	

FACILITY SPACE CLASSIFICATION REPORT

C 6		AGENCY	Code (1)	Title (2)		
State of Washington			376	The Evergreen State College		
Program (3)		Date of Inventory (4)		Page		(5)
		October 1977		2 of 4		Pages

Code (6)	Name (7)	SPACE CLASSIFICATION (Room or Use Type) (8)					Total Area (9)
		600 General Use	700 Support Facilities	800 Health Care	900 Residential	050 Inactive	
1	Daniel J. Evans Library	12,523	34,878	1,565	--	2,082	214,551
2	Lecture Halls	949	--	--	--	--	13,903
3	College Recreation Center	196	--	--	--	--	25,992
4	Laboratory Building, Phase I	6,175	1,561	--	--	--	46,722
4A	Laboratory Annex	--	--	--	--	--	8,532
5	Central Utility Plant	--	3,129	--	--	--	7,000
6	Shop & Shop Addition	21	10,582	--	--	--	10,888
7	Garage	--	1,194	--	--	--	1,287
8	Water Pump Station	--	--	--	--	--	--
9	Covered Recreation Pavilion	--	--	--	--	--	17,534
10	President's Residence	--	--	--	5,095	--	5,095
11	Seminar Building	1,281	2,862	--	--	161	20,912
12	Science Laboratory, Phase II	564	229	--	--	--	49,171
13	Combustible Storage Building	--	559	--	--	--	559
14	Communications Laboratory	780	--	--	--	--	41,929
16	Utility Tunnel & Substation	--	--	--	--	--	--
101	College Activities Building	33,659	1,728	--	--	--	40,636
102	Residence Hall "A"	258	377	--	27,710	--	29,324
103	Residence Hall "B"	--	--	--	14,725	--	14,725
104	Residence Hall "C"	--	--	--	14,678	--	14,678
105	Residence Hall "D"	--	--	--	14,756	--	14,756
201	Temporary Office Building	2,285	--	--	--	--	2,285
202	Grounds Office Trailer	--	--	--	--	--	476

FACILITY SIZE CLASSIFICATION REPORT

State of Washington		AGENCY	Code (1)	Title (2)	
			376	The Evergreen State College	
Program (3)		Date of Inventory (4)		Page 3 of 4 Pages (5)	
Instruction		October 1977			

Code (6)	Name (7)	SPACE CLASSIFICATION (Room or Use Type) (8)					Total Area (9)
		100 Classroom	200 Laboratory	300 Office	400 Study	500 Special Use	
205	Driftwood Daycare Center	--	--	--	--	1,223	(Cont'd on page 2)
206	Organic Farm	--	--	--	--	--	
210	Well House	--	--	--	--	--	
211	Temporary Art Studio	--	--	--	--	--	
212	Fire Station	--	--	130	--	--	
213	Temporary Fire Station Garage	--	--	--	--	--	
214	Fire Station Apparatus Room	--	--	--	--	--	
215	Vehicle & Equipment Storage	--	--	--	--	--	
216	Grounds Storage Green	--	--	--	--	--	
217	Grounds Storage White	--	--	--	--	--	
218	Marine Lab East	168	1,671	219	--	--	
300-318	Modular Housing (19 Units)	--	--	--	--	--	
319	Modular Housing Laundry	--	--	--	--	--	
TOTAL		50,293	122,023	85,873	49,015	81,718	

FACILITY SIZE CLASSIFICATION REPORT

C 6

State of Washington

AGENCY		Code (1)	Title (2)	
		376	The Evergreen State College	
Program (3)		Date of Inventory (4)		Page 4 of 4 Pages (5)
Instruction		October 1977		

Code (6)	Name (7)	SPACE CLASSIFICATION (Room or Use Type) (8)					Total Area (9)
		600 General Use	700 Support Facilities	800 Health Care	900 Residential	050 Inactive	
205	Driftwood Daycare Center	--	--	--	--	--	1,223
206	Organic Farm	--	--	--	1,054	--	1,054
210	Well House	--	--	--	--	--	0
211	Temporary Art Studio	1,803	--	--	--	--	1,803
212	Fire Station	126	2,150	--	--	--	2,406
213	Temporary Fire Station Garage	--	948	--	--	--	948
214	Fire Station Apparatus Room	--	747	--	--	--	747
215	Vehicle & Equipment Storage	--	1,750	--	--	--	1,750
216	Grounds Storage Green	--	52	--	--	--	52
217	Grounds Storage White	--	352	--	--	--	352
218	Marine Lab East	--	--	--	1,010	--	3,068
300-318	Modular Housing (19 Units)	--	--	--	27,436	--	27,436
319	Modular Housing Laundry	--	--	--	412	--	412
TOTALS		60,620	63,098	2,034	108,219	2,243	625,156

00288

12/8/77